

# Instruction Manual

JACK PIN DESIGNATIONS	TIA / EIA T568A	TIA / EIA T568B	INDUSTRIAL	
	1	White/Green	White/Orange	Yellow
	2	Green	Orange	Orange
	3	White/Orange	White/Green	White
	6	Orange	Green	Blue
	4	Blue	Blue	
	5	White/Blue	White/Blue	
	7	White/Brown	White/Brown	
	8	Brown	Brown	

① Insert cable through cable gland, follow the Cable Preparation according to cable used. Fan out all four pairs and cut the conductors as shown.

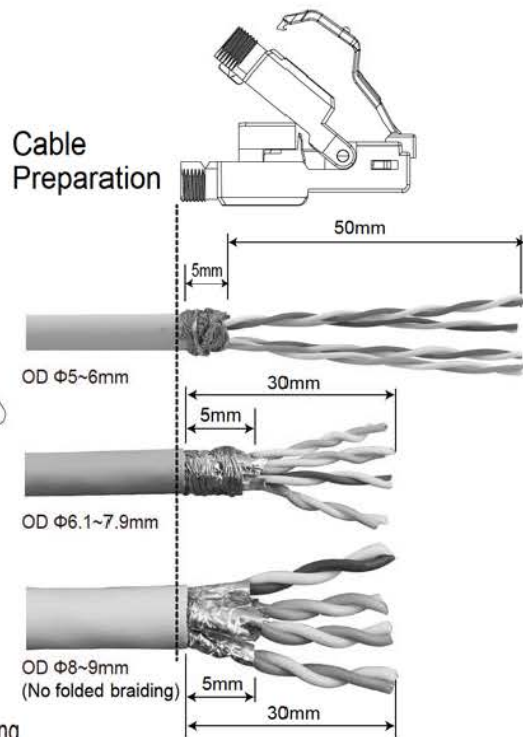
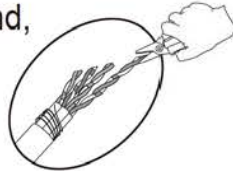

**Note:**

- a. Cable Bushing is placed inside the Cable Gland at factory, in case the Cable Bushing is pushed out, place back the Bushing as direction shown and continue installation.
- b. Cable Bushing may be removed while using Cable OD over 8mm.

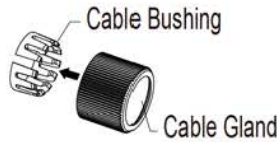

② Following the color coding label and allocate each conductor into proper slot on wiring cap. Trim the ends of excess conductors.

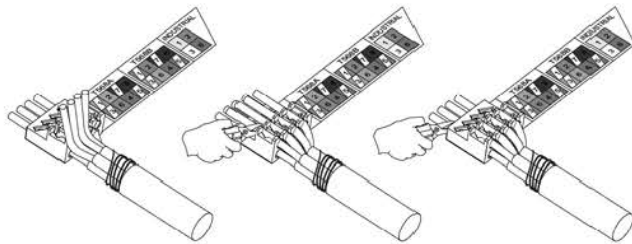

③ Remove the wiring label. Place the wiring cap onto plug, use plier to clamp wiring cap until it completely snap-in to effect the connection. Ensure the drain wire or braiding in contact with the grounding clip.

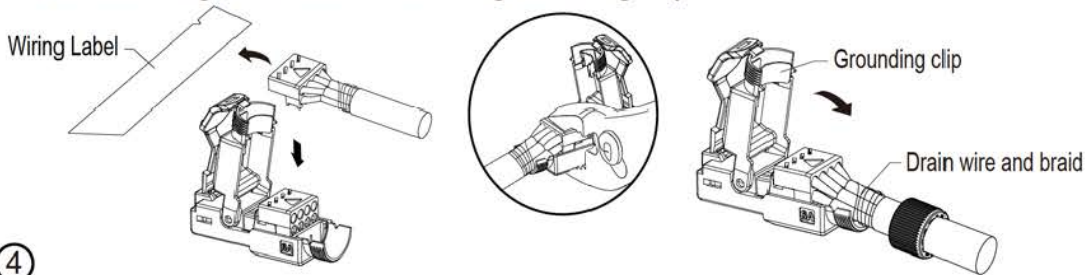

④ Close plug cover, make sure the drain wire is in proper contact with grounding clip on plug. Screw on the cable gland to fasten and complete installation.

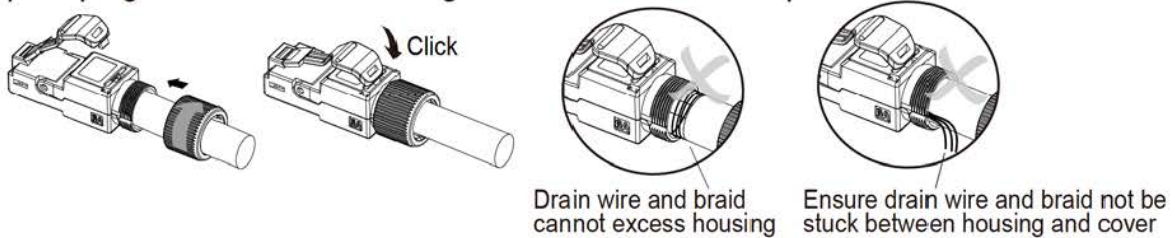

**Unload the cable**

